

# HALL LED CEILING EVO

ID CODE: 28

HALL LED CEILING EVO offers designers a broad collection of surface mounted downlights for ceiling applications. The product is available in **four sizes**: MINI, SMALL, MEDIUM and LARGE and in **many different outputs**. Along with the an ingress protection rating of IP44, plus a wide range of optics and accessories, the product is suited to a wide range of applications. Innovative CoB technology and the integrated driver deliver optimum efficacy and simple installation.

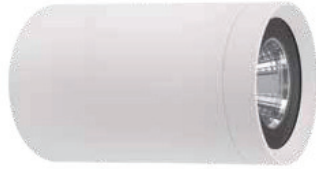

Design  
esse-ci

## FEATURES

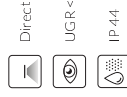

## LED



## CERTIFICATIONS



## ON REQUEST

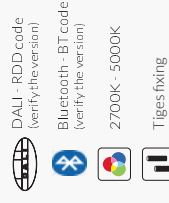

## Specifications

· Built-in driver  
· LED CoB technology

## Body

Manufactured from pressure die-cast aluminum with epoxy powder coating.

## Optic

· MINI: internal aluminum reflectors from 15° - 20° - 36° - 50° beam angles  
· SMALL: internal aluminum reflectors from 10° - 20° - 40° - 50° beam angles  
· MEDIUM and LARGE: internal aluminum reflectors from 10° - 12° - 20° - 40° - 70° beam angles

## Colour

○ White RAL 9003 wrinkled - Code: W  
● Black RAL 9005 wrinkled - Code: BK

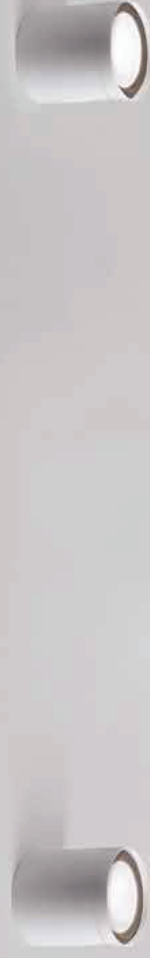

### HALL LED CEILING EVO MINI

**OPTIC**

Internal aluminum reflectors:  
15° - 20° - 36° - 50° beam angles.  
CUT OFF > 30°

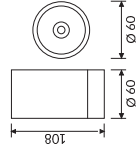

IP 44 A+

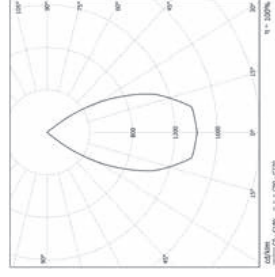

### HALL LED CEILING EVO SMALL

**OPTIC**

Internal aluminum reflectors:  
10° - 20° - 40° - 50° beam angles.  
CUT OFF > 30°

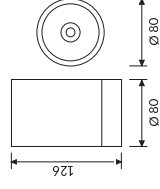

IP 44 A+

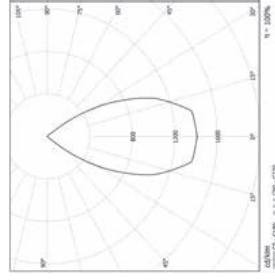

IP 44 A+

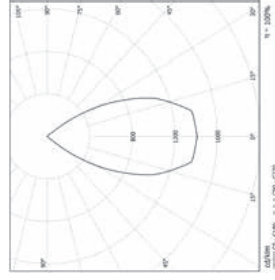

**COLOUR TEMPERATURE**

**4000K**

COD	Im
28VT9L49015	9W 15°
28VT9L49020	9W 20°
28VT9L49036	9W 36°
28VT9L49050	9W 50°

**3000K**

COD	Im
28VT9L39015	9W 15°
28VT9L39020	9W 20°
28VT9L39036	9W 36°
28VT9L39050	9W 50°

**COLOUR TEMPERATURE**

**4000K**

COD	Im
28VT13L49010SE	13W 10°
28VT13L49020SE	13W 20°
28VT13L49040SE	13W 40°
28VT13L49050SE	13W 50°
28VT18L49010SE	18W 10°
28VT18L49020SE	18W 20°
28VT18L49040SE	18W 40°
28VT18L49050SE	18W 50°

**3000K**

COD	Im
28VT13L39010SE	13W 10°
28VT13L39020SE	13W 20°
28VT13L39040SE	13W 40°
28VT13L39050SE	13W 50°
28VT18L39010SE	18W 10°
28VT18L39020SE	18W 20°
28VT18L39040SE	18W 40°
28VT18L39050SE	18W 50°

### HALL LED CEILING EVO MEDIUM

### HALL LED CEILING EVO LARGE

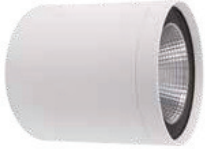

**OPTIC**

Internal aluminum reflectors:  
10°- 20°- 40°- 70° beam angles.  
CUT OFF > 30°.

**OPTIC**

Internal aluminum reflectors:  
12°- 20°- 40°- 70° beam angles.  
CUT OFF > 30°.

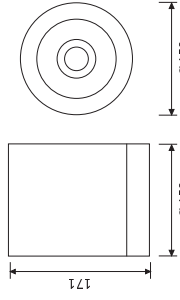
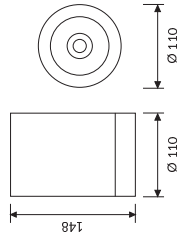
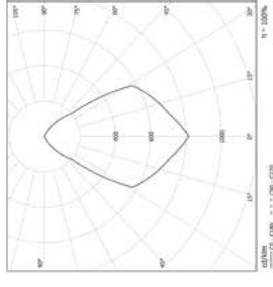
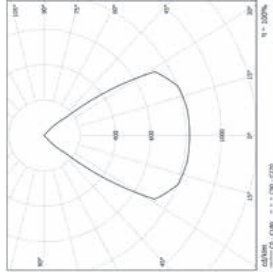

**COLOUR TEMPERATURE**

4000K		3000K	
COD	Im	Im	Im
28VT18L49010ME	18W 10°	18W 10°	2240
28VT18L49020ME	18W 20°	18W 20°	2240
28VT18L49040ME	18W 40°	18W 40°	2240
28VT18L39070ME	18W 70°	18W 70°	2240
28VT25L49010ME	25W 10°	25W 10°	3048
28VT25L49020ME	25W 20°	25W 20°	3048
28VT25L49040ME	25W 40°	25W 40°	3048
28VT25L49070ME	25W 70°	25W 70°	3048

**COLOUR TEMPERATURE**

4000K		3000K	
COD	Im	Im	Im
28VT35L49012LE	35W 12°	35W 12°	3897
28VT35L49020LE	35W 20°	35W 20°	3897
28VT35L49040LE	35W 40°	35W 40°	3897
28VT35L39070LE	35W 70°	35W 70°	3897
28VT38L49012LE	38W 12°	38W 12°	4100
28VT38L49020LE	38W 20°	38W 20°	4100
28VT38L39040LE	38W 40°	38W 40°	4100
28VT38L39070LE	38W 70°	38W 70°	4100
28VT52L49012LE	52W 12°	52W 12°	5494
28VT52L49020LE	52W 20°	52W 20°	5494
28VT52L49040LE	52W 40°	52W 40°	5494
28VT52L49070LE	52W 70°	52W 70°	5494

## Accessories

**28AA16SE**

Wire suspension kit for SMALL version. Cable length 2000mm.

**28AA16ME**

Wire suspension kit for MEDIUM version. Cable length 2000mm.

**28AA16LE**

Wire suspension kit for LARGE version. Cable length 2000mm.

**28AA16SPE**

5 pole-powered supply box for SMALL version. Cable length 2000mm.

**28AA16SME**

5 pole-powered supply box for MEDIUM version. Cable length 2000mm.

**28AA16SPE**

5 pole-powered supply box for LARGE version. Cable length 2000mm.



**28AA60AGW**: Mini version  
White RAL 9003 ring.

**28AA60AGWBK**: Mini version  
White RAL 9003 ring with  
black RAL 9005 interior.

**28AA60AGBK**: Mini version  
Black RAL 9005 ring.



**28AA80SAGW**: Small version  
White RAL 9003 ring.

**28AA80SAGWBK**: Small version  
White RAL 9003 ring with  
black RAL 9005 interior.

**28AA80SAGBK**: Small version  
Black RAL 9005 ring.



**28AA110MAGW**: Medium version  
White RAL 9003 ring.

**28AA110MAGWBK**: Medium version  
White RAL 9003 ring with  
black RAL 9005 interior.

**28AA110MAGBK**: Medium version  
Black RAL 9005 ring.

## Technical Note

## INSTALLATION

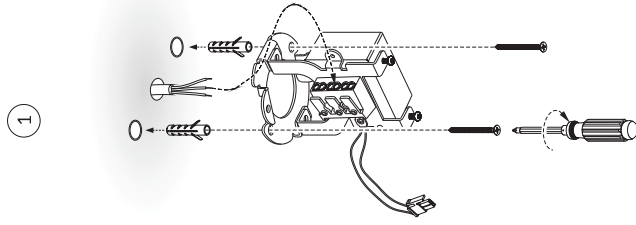

1

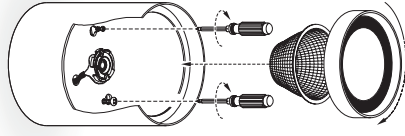

2

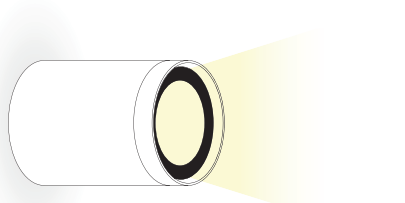

3

## ANTI-GLARE RINGS

Anti-glare rings that allow to focus the light beam hiding the light source. They perfectly fit in art galleries, museums and retail areas to value the subject with accent light without annoying glare issues.